

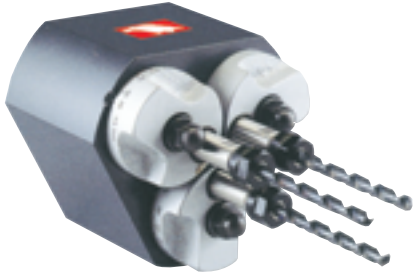

Multi-Spindle Drill Head



- The helical driving gears give high torque transmission effect.
- The Drill head accommodates high running speed up to 5500 RPM.
- Reversible spindle running permits it ideal for both drilling and tapping operations.



V33C
3 SPINDLE & CIRCULAR TYPE

V40C
4 SPINDLE & CIRCULAR TYPE

V33C

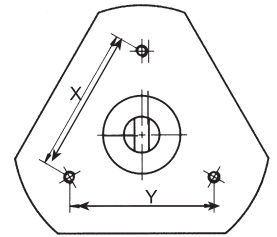
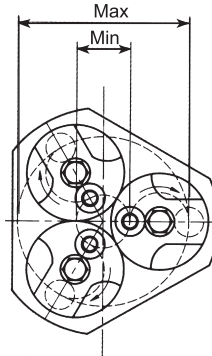
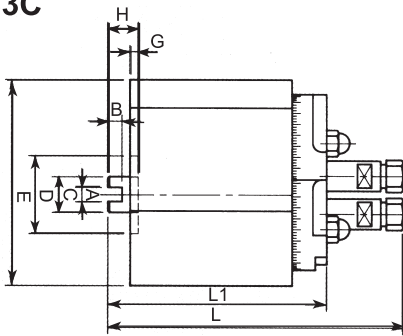

ORDER NO.	A	B	C	D	E	G	H	L	L1	X	Y	ADJ. SPACING		MAX. CAPACITY COLLET RANGE	KGS	CODE NO.
												MIN.	MAX.			
V33C-T7					130			149	109			∅28	∅100	ER-11, ∅7~∅1	5.5	7002-200
V33C-T10	10	10	30	55	155	3	15	152	112	86.6	86.6	∅32	∅116	ER-16, ∅10~∅1	10.5	7002-201
V33C-T12					172			162	122			∅38	∅138	ER-20, ∅13~∅1	13	7002-202
V40C-T7					145			152	112			∅42	∅114	ER-11, ∅7~∅1	6.5	7002-203
V40C-T10	10	10	30	55	172	3	15	152	112	70.7	70.7	∅48	∅132	ER-16, ∅10~∅1	12.5	7002-204
V40C-T12					192			162	122			∅58	∅158	ER-20, ∅13~∅1	14	7002-205

THE ER-COLLET IS OPTIONAL

V40C

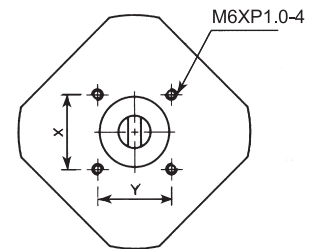
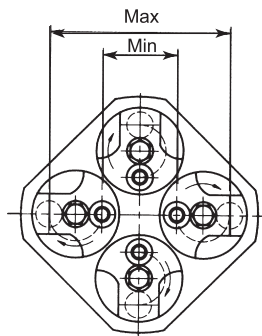
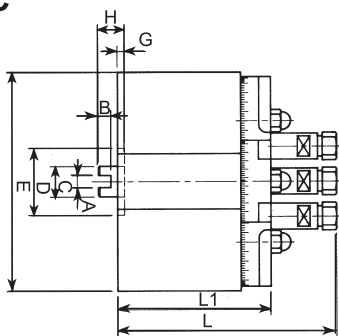

When ordering please provide the dimensions in mm unit on the spindle. This size is for mounting collar using.

F Chuck taper					
No	JT1	JT2	JT6	JT3	JT4
C	21	22.4	26.3	31.3	45
E	8.6	14	16	19.3	26.4

F Chuck taper					
No	B10	B12	B16	B18	B20
C	18	22	29	27	45.5
E	9.4	11.1	14.5	16.2	19.8

