



2-Jaw Steel Body Chucks

Steel Body Chucks Series



NEW

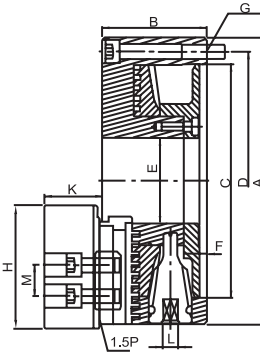
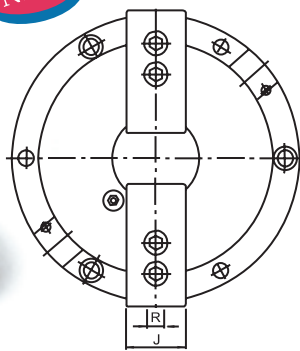

Steel Body Chucks

1. Hard jaws and soft jaws can be adjusted just like on a Hydraulic power Chuck to increase the gripping range.
2. Hard jaws as well as Soft jaws are interchangeable with those of CNC Lathes.
3. Can be used as a "Forming plate" for machining soft Jaws.
4. The Chuck Handle can be operated easily and smoothly.
5. Chuck Body is made by steel to enhance safety operations for high speed machining.

SPECIFICATIONS

UNIT:mm

ORDER NO.	A	B	C	D	E	F	G	H	J	K	L	M	R	Gross weight (Kg)	Max. speed (r.p.m)	Max. Gripping Diameter		CODE NO.
																O.D.Clamping	I.D.Clamping	
VTNT-07	193	78	155	172	58	5	3-M10	90	42	44	11	20	12	15.8	3200	Ø8~Ø235	Ø66~Ø235	5005-031
VTNT-09	233	85	190	210	70	6	3-M12	100	48	47	12	25	14	24.5	2800	Ø11~Ø280	Ø85~Ø280	5005-032



3-Jaw Steel Body Chucks

Steel Body Chucks Series



NEW

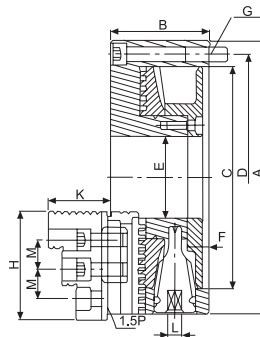
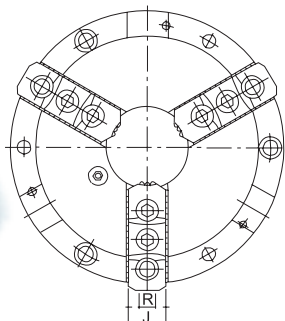

Steel body chucks:

1. Chuck Body is made by steel to enhance safety operations for high speed machining.
2. Hard jaws as well as Soft jaws are interchangeable with those of CNC Lathes.
3. The Chuck Handle can be operated easily and smoothly.
4. Can be used as a "Forming plate" for machining soft jaws.
5. Hard jaws and soft jaws can be adjusted just like on a Hydraulic power Chuck to increase the gripping range.

SPECIFICATIONS

UNIT:mm

ORDER NO.	A	B	C	D	E	F	G	H	J	K	L	M	R	Gross weight (Kg)	Max. speed (r.p.m)	Max. Gripping Diameter		CODE NO.
																O.D.Clamping	I.D.Clamping	
VNT-07	193	78	155	172	58	5	3-M10	78	28	46	11	20	12	14.8	3200	Ø8~Ø235	Ø66~Ø235	5005-040
VNT-09	233	85	190	210	70	6	3-M12	92	32	53	12	25	14	23.4	2800	Ø11~Ø280	Ø85~Ø280	5005-041
VNT-10	273	91	230	250	89	6	3-M12	104	37	56	12	30	16	32	2400	Ø12~Ø330	Ø92~Ø330	5005-042
VNT-12	310	104	260	285	105	7	3-M12	118	47	67	14	30	21	46	2100	Ø15~Ø370	Ø104~Ø370	5005-043

ILLUSTRATE:



Can for more large capacity.



The hard jaw & soft jaw is same as hydraulic power chuck