



2 - Jaw Hollow Power Chuck Fixtures

Pneumatic Chucks Series



NEW

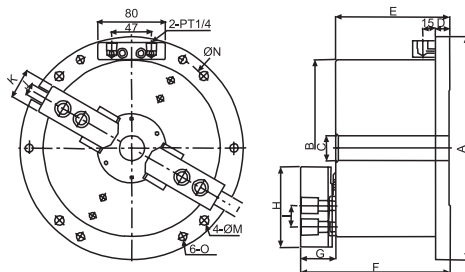

The feature is same as 3 - jaw hollow power chuck

SPECIFICATIONS

ORDER NO.	A	B	C	D	E	F	G	H	I	J	K	L	M	N	O
VMOT-05	185	135	-	15	95	128	33	62	14	10	25	13	Ø13	Ø165	M8
VMOT-06	224	169	25	16	118	158	40	73	20	12	31	18	Ø13	Ø202	M10
VMOT-08	265	210	30	17	135	177	42	95	25	14	35	18	Ø13	Ø243	M10
VMOT-10	315	254	52	17	145	191	46	110	30	16	40	18	Ø13	Ø228	M12

UNIT:mm

ORDER NO.	Piston Area (cm ²)	Plunger stroke (mm)	Jaw stroke (Diameter)mm	Max. gripping force (kgf)	Max. Pressure Setting (kgf/cm ²)	Gripping Force(kgf) (air press 6kg/cm ²)	Gross Weight (kg)	Gripping Range	CODE NO.
VMOT-05	74	10	5.4	2600	14	1300	12	Ø12~Ø135	5005-060
VMOT-06	99	12	5.5	4000	15	1800	22.4	Ø15~Ø169	5005-061
VMOT-08	156	16	7.4	6300	15	2800	37.8	Ø20~Ø210	5005-062
VMOT-10	204	19	8.8	8600	15	3700	56.9	Ø33~Ø254	5005-063



3 - Jaw Hollow Power Chuck Fixtures

Pneumatic Chucks Series



NEW

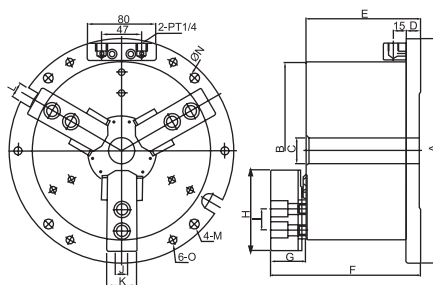

OPTIONAL



PNEUMATIC MANUAL SWITCH



EXAMPLES OF ATTACHING PNEUMATIC MANUAL SWITCH / OPTIONAL ACCESSORIES

- Dusts-proof and Waterproof**
Dust-proof and Waterproof structure prevents work-chips and coolant water to enter into inside of chucks. Thus longer life is consequential. High efficiency and less working pressure can be achieved by less trouble, and consistency of quality.
- Benefit of Built-in Cylinder**
The cylinder on inside of chuck is connected to chuck itself directly for obtaining better stability, less space, and higher machining efficiency.
- Rust-proof for Pneumatic Cylinder**
Inside wall of cylinder being rustproof treated; cylinder can work under wet or high moisture circumstances without rusty and seized trouble.
- Available for Quick Fixture Change**
MO Chucks can be easily fixed on a plate fixture for quick changes.
- Flange Design**
The flange makes it easy to be locked on T-slot of worktable.
- Hard jaws and Soft jaws are Interchangeable with those of CNC Lathes**
Hard jaws and Soft jaws are same as those of CNC Lathes, therefore; they are interchangeable to reduce cost of spare jaws.

With built-in type cylinder, it is ideal for machining application on working table

SPECIFICATIONS

ORDER NO.	A	B	C	D	E	F	G	H	I	J	K	L	M	N	O
VMO-05	185	135	-	15	95	128	33	62	14	10	25	13	Ø9	Ø165	M8
VMO-06	224	169	25	16	118	158	40	73	20	12	31	18	Ø11	Ø202	M10
VMO-08	265	210	30	17	135	177	42	95	25	14	35	18	Ø11	Ø243	M10
VMO-10	315	254	52	17	145	191	46	110	30	16	40	18	Ø13	Ø228	M12

UNIT:mm

ORDER NO.	Piston Area (cm ²)	Plunger stroke (mm)	Jaw stroke (Diameter)mm	Max. gripping force (kgf)	Max. Pressure Setting (kgf/cm ²)	Gripping Force(kgf) (air press 6kg/cm ²)	Gross Weight (kg)	Gripping Range	CODE NO.
VMO-05	74	10	5.4	4000	17	1300	12.4	Ø12~Ø135	5005-070
VMO-06	99	12	5.5	6000	19	1800	23	Ø15~Ø169	5005-071
VMO-08	156	16	7.4	9500	20	2800	38.5	Ø20~Ø210	5005-072
VMO-10	204	19	8.8	13000	20	3700	58	Ø33~Ø254	5005-073