

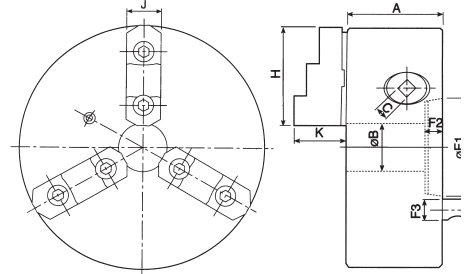

# 3-Jaw Strong Scroll Chucks D1 Camlock Direct Mounting

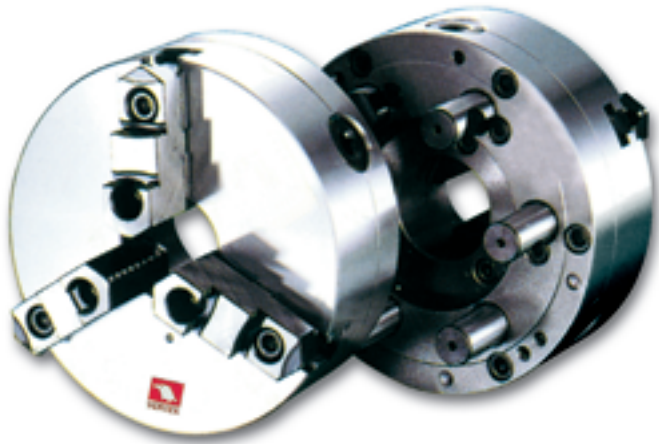

(ASA spindle nose D1-4,D1-5,D1- 6,D1-8)

American standard camlock type with 2-piece reversible hard top jaws.

1.Gripping accuracy of 0.03mm(0.002inch)T.I.R.

2.Standard accessories

A chuck wrench and hex. key One set of mounting bolts.(UNC-bolts)

3.The body is made of MEEHANITE.

It is suitably used for high speed revolution and 3 times more durable than regular chucks.

## SPECIFICATIONS

Unit:mm

ORDER NO.	DIM Spindle Size	Chuck Size	A	B	C	H	J	K	Mounting Dimensions				Gripping Range		Weight (kg)	Allowable Handle Torque (kgf.m)	Gripping Force (kgf)	I (kgf.m <sup>2</sup> )	Max. Speed (r.p.m.)	CODE NO.
									F1	F2	F3	F4	O.D. range	I.D. range						
KD4-6"	D1-4	165	72	46	10	72	26	39	63.5	13	15.8	82.55	Ø8-Ø160	Ø55-Ø150	11	90	3300	0.04	4000	5002-060
KD5-8"	D1-5	200	77	46	11	82	28	42	82.563	14.3	19	104.78	Ø8-Ø180	Ø62-Ø170	18	11.5	3600	0.07	3200	5002-061
KD6-8"	D1-6	200	77	58	11	82	28	42	106.375	16	22	133.35	Ø8-Ø180	Ø62-Ø170	17	17	3600	0.07	3200	5002-063
KD6-10"	D1-6	250	86	76	12	96	32	50	106.375	16	22	133.35	Ø11-Ø220	Ø70-Ø210	29.5	19.5	4800	0.2	2500	5002-064
KD6-12"	D1-6	306	107	103	14	114	40	57	106.375	16	22	133.35	Ø15-Ø300	Ø90-Ø290	47	21.0	5700	0.5	2200	5002-065



# 4-Jaw Independent Chuck Plain Back

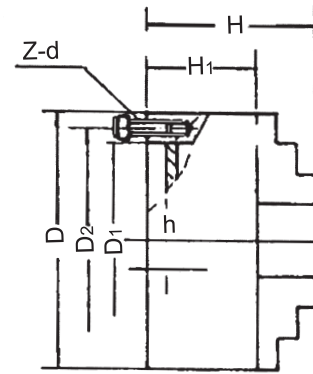
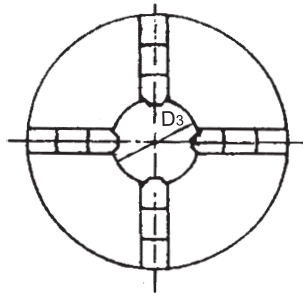

Unit:mm

ORDER NO.	D-Size	D1	D2	D3	H	H1	h	Z-d	WEIGHT	CODE NO.
VKC-4	100mm(4")	72	84	25	74	54	4.5	4-M8	4	5002-220
VKC-5	125mm(5")	95	108	30	78	56			5002-221	
VKC-6	160mm(6")	65	95	45	93	65	5	4-M10	9	5002-222
VKC-8	200mm(8")	75		56	107	75			15.5	5002-223
VKC-10	250mm(10")	110	75	120	80	27			5002-224	
VKC-12A	300mm(12")	152	130	75	134	90	6	4-M12	27	5002-225
VKC-12B	320mm(12")	140							165	43
VKC-14	350mm(14")	130	168	95	134	90			54	5002-227
VKC-16	400mm(16")	160	185	125	143	95	8	4-M16	60	5002-228
VKC-20	500mm(20")	200	236	160	161	106			105	5002-229
VKC-25	630mm(25")	220	258	180	180	118	10	4-M20	175	5002-230
VKC-32	800mm(32")	250	300	210	202	132			300	5002-231