

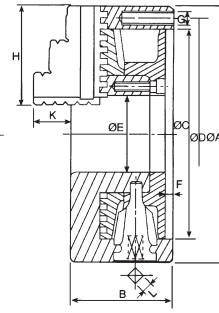

3-Jaw Scroll Chuck

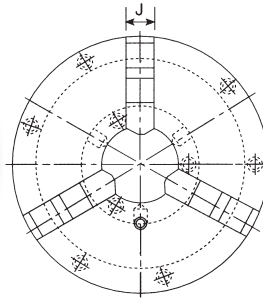

1. Interchangeable utilization of internal and external hard jaws.
2. VSC types feature economical and durable, suitable for mass production.
3. Gripping accuracy of 0.03mm (0.012inch) T.I.R..
4. The body is made of MEEHANITE. It is suitably used for high speed revolution and 3 times more durable than regular chucks.

SPECIFICATIONS

Unit:mm

ORDER NO.	Dim											Allowable Handle Torque (kgf.m)	Gripping Force (kgf)	I (kgf.m ²)	Weight (kg)	Max. Speed (r.p.m.)	Gripping Range		CODE NO.
	A	B	C	D	E	F	G	H	J	K	L						O.D.range	I.D.Range	
VSC-3	85	46	60	73	16	4	3-M6	36	11	15	7	3.0	900	—	1.7	3500	Ø2-Ø70	Ø24-Ø64	5002-001
VSC-4	112	59	80	95	24	4.5	3-M8	42	14	18	8	4.5	1200	—	3.7	2500	Ø3-Ø90	Ø32-Ø84	5002-002
VSC-5	132	60	100	115	32	4.5	3-M8	50	16	20	8	6.5	1500	0.01	5.2	2500	Ø3-Ø110	Ø35-Ø100	5002-003
VSC-6	165	67	130	147	45	5	3-M10	63	19	27	10	9.0	3300	0.03	9.3	4000	Ø3-Ø160	Ø48-Ø150	5002-004
VSC-7	192	76.5	155	172	58	5	3-M10	77	21.5	28	11	11.0	3600	0.06	14.2	3500	Ø4-Ø180	Ø56-Ø170	5002-005
VSC-8	200	76.5	160	176	58	5	3-M10	77	21.5	38	11	11.0	3600	0.07	16	3200	Ø4-Ø180	Ø56-Ø170	5002-006
VSC-9	232	84	190	210	70	6	3-M12	87	24	33	12	15.0	3900	0.15	22.7	2900	Ø5-Ø220	Ø62-Ø210	5002-007
VSC-10	273	87	230	250	87	8.5	3-M12	98	28	37	12	19.5	4800	0.25	31.8	2500	Ø6-Ø260	Ø70-Ø250	5002-008
VSC-12	310	96	260	285	105	7	3-M12	110	30	44	14	21.0	5700	0.58	44.8	2200	Ø10-Ø300	Ø86-Ø290	5002-009
VSC-16	405	122	345	375	145	8.5	6-M14	146	42	56	15	23.0	4500	1.75	102	1500	Ø14-Ø400	Ø100-Ø380	5002-010



4-Jaw Scroll Chuck

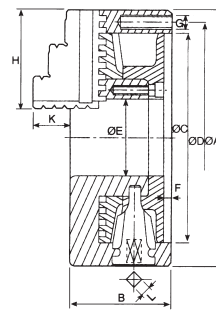
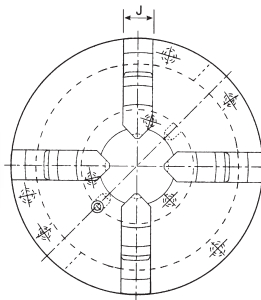

1. Gripping of square or octagonal workpiece could fit into central line automatically.
2. SIC have high stability in gripping thin tube work piece.
3. The specification is the same as VSC type.
4. The body is made of MEEHANITE. It is suitably used for high speed revolution and 3 times more durable than regular chucks.

SPECIFICATIONS

Unit:mm

ORDER NO.	Dim											Allowable Handle Torque (kgf.m)	Gripping Force (kgf)	I (kgf.m ²)	Weight (kg)	Max. Speed (r.p.m.)	Gripping Range		CODE NO.
	A	B	C	D	E	F	G	H	J	K	L						O.D.range	I.D.Range	
VPS-7	192	76.5	155	172	58	5	3-M10	77	21.5	28	11	11.0	3600	0.06	14.8	3500	Ø4-Ø180	Ø56-Ø170	5002-200
VPS-9	232	75	190	210	70	6	3-M12	87	24	33	12	15.0	3900	0.16	23.2	2900	Ø5-Ø220	Ø62-Ø210	5002-201
VPS-12	310	96	260	285	105	7	3-M12	110	30	44	14	21.0	5700	0.58	47	2200	Ø10-Ø300	Ø86-Ø290	5002-202
VPS-16	405	122	345	375	145	8.5	6-M14	146	42	56	15	23.0	4500	1.72	107	1500	Ø14-Ø400	Ø100-Ø380	5002-203