

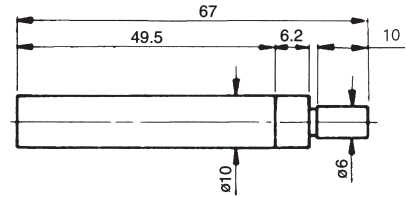

Touch Point Sensor

With Beeper



CERAMIC TYPE VPS-201C

The series is a high precision setting device for positioning the accurate center between tool spindle of machine and reference surface of working at low-cost and saving time.

Accuracy ; within 0.005 mm

Made of tool steel, hardened and ground.

Suitable rotation speed : VPS-201-450 to 600rpm.

VPS-401-600 to 1,000 rpm

MECHANICAL TYPE SIMPLE TYPE

ORDER NO.	VPS-201	VPS-201C
CODE NO.	3402-005	3402-007
WEIGHT(kg)	0.1	0.1

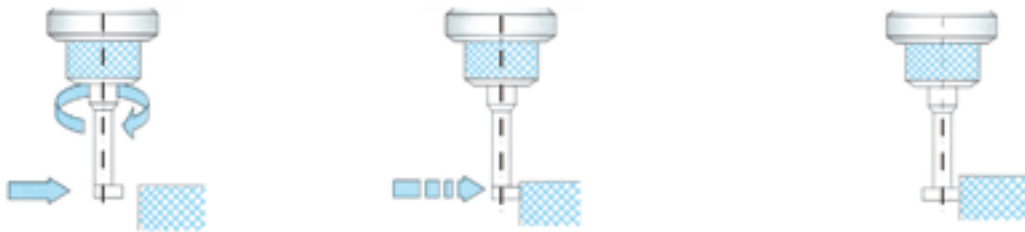

Touch Point Sensor

VPS-401 (2 PCS/SET)
VPS-402A(LONG) SINGLE
VPS-402B(SHORT) SINGLE

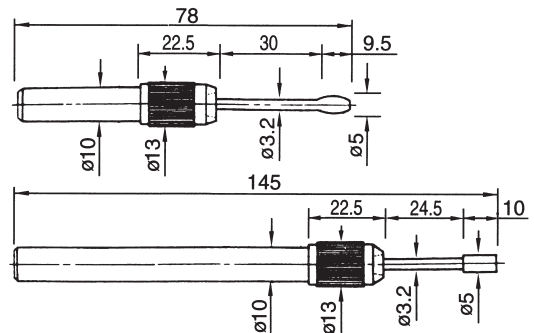

DELUXE TYPE

ORDER NO.	VPS-401 (2PCS/SET)
CODE NO.	3402-006
WEIGHT(kg)	0.18

FEATURES

1. Material: high-carbon steel.
2. Accuracy within 0.003mm
3. Hardness: HRC $58^{\circ} \pm 1^{\circ}$
4. R.P.M. Within 600-1000
5. Suitable for milling machine, Drill machine, and boring machine.

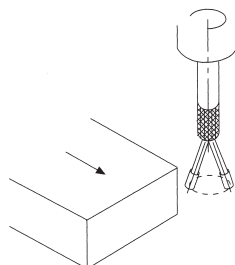

EXAMPLES-APPLICATION

