



# Dustproof Halogen Lamp UNIVERSAL TYPE

- Fitted with coil transformer resisting unstable voltage.
- Long service life.



**VHL-300L**



**VHL-300M**



**VHL-300S**

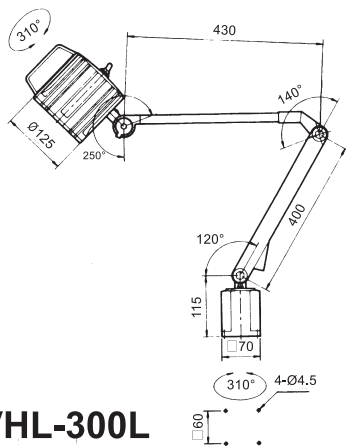

**VHL-300L  
LONG ARM**

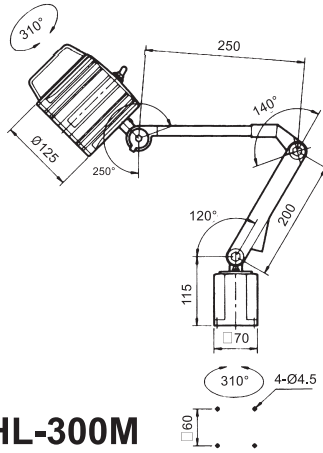

**VHL-300M  
MEDIUM ARM**

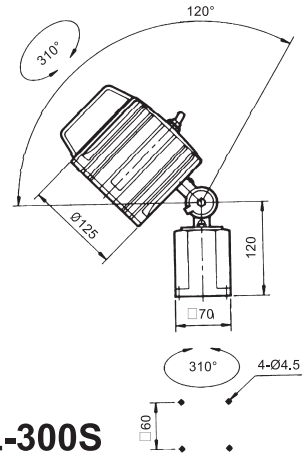

**VHL-300S  
SHORT ARM**

• **OPTIONAL** •

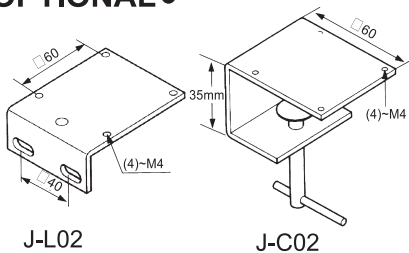

- **MOUNTING ANGLE PLATE J-L02**
- **MOUNTING CLAMP J-C02**

Totally enclosed lighting head provides well prevention for explosion, dust, coolant, and lubricants.

Uses efficient quartz halogen bulb, great light output, soft illuminating without irritating to the eyes.

Unit:mm

ORDER NO.	ARM LENGTH L x l	WEIGHT (kg)	CODE NO.
<b>VHL-300L</b>	430X400	3.5	1025-001
<b>VHL-300M</b>	250X200	3.2	1025-002
<b>VHL-300S</b>	1 JOINT	2.4	1025-003
<b>J-L02</b>		0.4	1025-004
<b>J-C02</b>		0.4	1025-005

## FEATURES

- Coil transformer built in base for directly connect to voltage of Ac power. (110V, 220V, 380V.....)
- Specify voltage as desired when ordering.
- It accepts bulb 50W.
- Furnished with 1.8 meter cord with plug.